

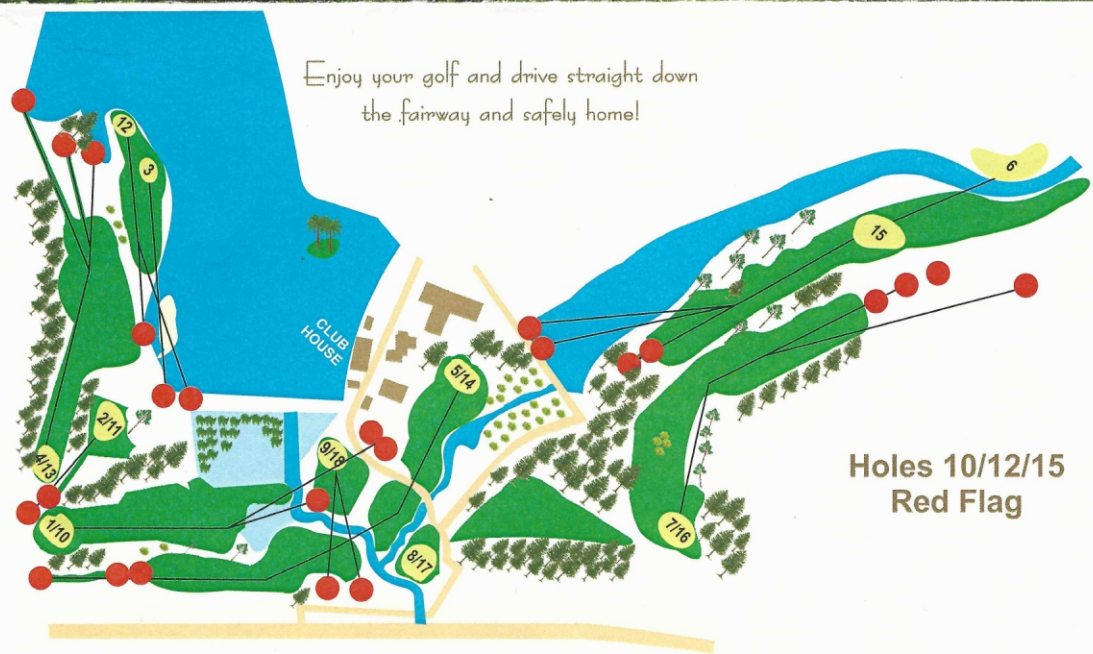

PO Box 255 • Greytown • 3250 • Tel: 033 417 1009 • Fax: 086 232 7612
Julian: 082 772 6799 • Sales: 076 790 8500
www.cpsseedlings.co.za 



ST. CATHRYN'S Est 1993 GOLF ESTATE

'A Golfing Estate in Paradise'



DATE	TIME		COMPETITION																	
PLAYER				TEE	HI	CH	MARKER							TEE	HI	CI				
A							C													
B							D													
HOLE	NAME	PAR	STROKE	PLAYER SCORE			RESULT			MARKER SCORE				WHITE (m)	BLUE (m)	RED (m)				
				A	B		A/B	ALLIANCE	C/D	C		D								
1	Otto's Road	4	6										346	258	256					
2	E.D.	3	10										145	124	117					
3	Captain Giles	4	18										228	175	172					
4	Compound	4	14										397	341	282					
5	Amen Corner	5	12										463	419	416					
6	Trout Dam	5	2										498	414	411					
7	Crushpen	4	4										405	405	342					
8	Augusta	4	8										278	264	260					
9	Steve	3	16										141	133	133					
Out		36											2901	2533	2389					
10	Shalaza	4	3										368	258	256					
11	W.T.C.	3	17										130	124	117					
12	Rudi's Loch	4	7										293	231	206					
13	Ngena Elhatini	4	15										347	341	282					
14	Aussicht	5	1										514	463	419					
15	Bremen Straße	4	9										361	286	280					
16	Potspruit	5	11										473	398	387					
17	Louise	4	5										333	268	264					
18	Cold Beer	3	13										143	140	138					
IN		36											2962	2509	2349					
OUT		36											2901	2533	2389					
TOTAL		72											5863	5042	4738					
				HANDICAP										Course rating MEN			Course rating WOMAN			
				NETT										WHITE (m)	BLUE (m)	RED (m)	WHITE (m)	BLUE (m)	RED (m)	
TWO CLUBS														CR	70.7	67.2	65.2	77.5	72.6	70.3
Players Name				HOLE										SR	132	112	106	144	129	120

PLAY THE COURSE THAT SUITS YOUR GAME

STABLEFORD POINTS
OR PAR RESULTS

LOCAL RULES REFER TO YOUR MARKER

- Placing is allowed on the fairway in play (1 club length)
- Out of bounds:** a ball is out of bounds when it comes to rest:
 - Beyond all perimeter fences and white posts.
 - On holes 5 & 14 from behind the 1st tee box beyond the white post.
- WATER HAZARDS & STAKED AREAS (Rule 26)**
 - Water hazards are defined by YELLOW stakes
 - Lateral water hazards and penalty areas are defined by RED stakes
 - Environmentally sensitive areas are defined by BLUE stakes*
***(ball must be found, drop nearest point of relief, without penalty)**
- DISTANCES**

All distances are measured from the permanent marker on the T box through the middle of the fairway to the centre of the green.
- PLANTED TREES AND ALOES**

If a young tree under the height of 2m or an aloe interferes with a players stance or stroke, the player MUST drop the ball within one club length not nearer the hole from nearest point of relief without penalty.
- POWER LINES OR CABLES**

If a players ball hits power line cables overhanging the course, the player MUST replay the shot without penalty.
- GUR:** The player MUST drop within a club length from the nearest point of relief - **the ball must be found.**
 - All areas enclosed by a white dotted line or marked GUR
 - Gravelled roads within one club length from the edge of the road.
 - All flower beds
 - Sprinkler heads
 - Electric fence - if the fence interferes with a players stroke or stance the player MUST drop within one club length not nearer the hole from the nearest point of relief.
- Please check the notice board for supplementary local rules.
- Please repair divots, avoid slow play. Play ready golf.
- Please take note of the local weather rule posted on the notice board.
- COUNT OUT HOLES:** 2; 7; 10; 15; 16 and then thereafter second nine holes thereafter the first nine holes.

PLAYERS SIGNATURE

MARKERS SIGNATURE